

ROTARY AIRLOCK

MODEL 257

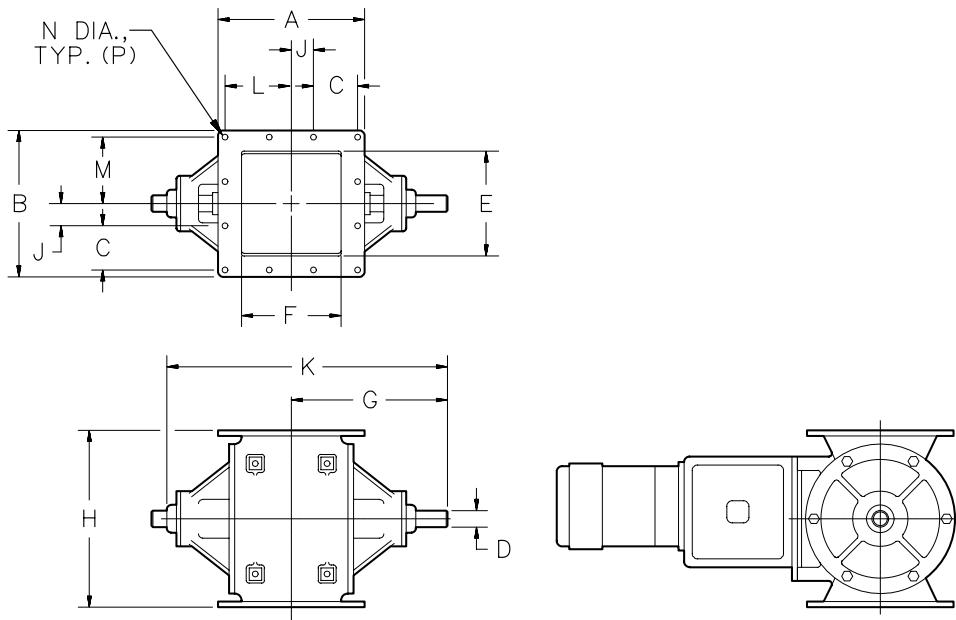

Size	Displ.*	A	B	C	D	E	F	G	H	J	K	L	M	N	P	Wt. Vlv. Only	Tot. Wt. W/Drive
4 X 4	.02	5.50"	5.50"	—	.94"	3.50"	3.50"	9.63"	7.75"	1.25"	16.75"	2.38"	2.38"	.31"	8	40	100
6 X 6	.07	8.00"	8.00"	—	1.00"	5.50"	5.50"	11.19"	10.00"	1.88"	19.88"	3.63"	3.63"	.43"	8	80	165
8 X 8	.18	11.00"	11.00"	—	1.38"	7.50"	7.50"	12.13"	12.00"	2.50"	21.75"	4.88"	4.88"	.43"	8	140	250
10 X 10	.36	13.25"	13.25"	4.00"	1.63"	9.50"	9.50"	14.63"	15.00"	2.00"	26.75"	6.00"	6.00"	.56"	12	255	395
12 X 12	.64	16.25"	16.25"	4.88"	2.00"	11.25"	11.25"	18.88"	18.25"	2.44"	34.25"	7.31"	7.31"	.56"	12	435	630
12 X 21	1.08	25.00"	16.00"	4.75"	2.00"	11.00"	20.00"	23.13"	15.00"	2.38"	42.75"	11.88"	7.13"	.56"	16	560	770
14 X 14	1.05	19.00"	19.00"	4.25"	2.50"	14.00"	14.00"	21.63"	21.00"	4.25"	39.25"	8.50"	8.50"	.56"	16	710	975
16 X 16	1.62	22.00"	22.00"	5.00"	2.50"	16.00"	16.00"	22.63"	24.00"	5.00"	41.25"	10.00"	10.00"	.56"	16	900	1180
18 X 18	2.29	24.00"	24.00"	5.25"	2.50"	18.00"	18.00"	23.63"	27.00"	5.25"	43.25"	10.50"	10.50"	.69"	16	1200	1530
22 X 22	4.10	28.00"	28.00"	5.00"	2.50"	22.00"	22.00"	25.63"	31.00"	2.50"	47.25"	12.50"	12.50"	.69"	20	1600	2080
30 X 30	11.30	36.00"	36.00"	6.75"	3.38"	30.00"	30.00"	29.50"	39.00"	3.38"	55.00"	16.88"	16.88"	.69"	20	2600	3210

*DISPLACEMENT GIVEN IN CUBIC FEET PER REVOLUTION AT 100% EFFICIENCY

STANDARD FEATURES:

- Heavy-duty flanged connection
- Air tight seal to 15 PSIG
- Lifetime sealed bearings
- Large diameter shaft
- Full flow design
- Adjustable packing glands
- Cast iron construction
- High capacity rotor

OPTIONAL FEATURES:

- Interior coatings
- Air purge
- Vents
- Special rotors
- Regreasable and high temp bearings
- Lantern rings
- Special packing gland materials
- Inspection door
- Stainless construction
- Aluminum construction
- High Temperature