

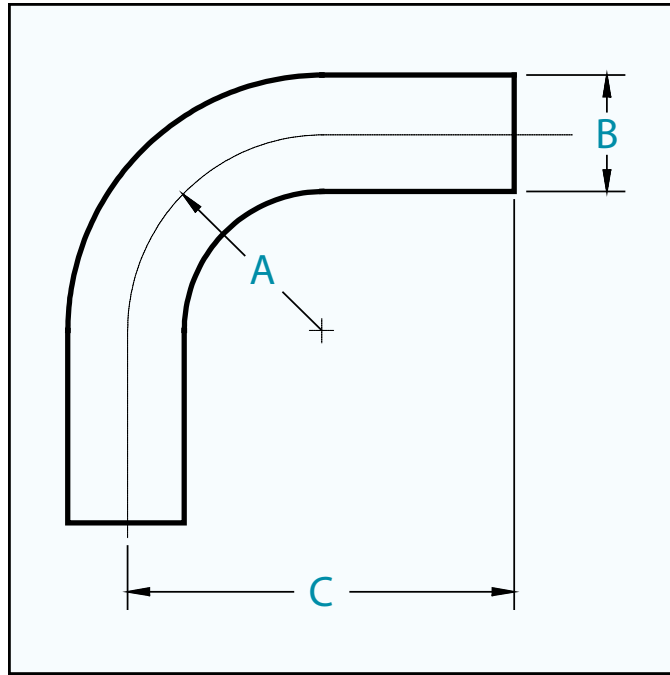

# Model 392 PLAIN FORMED 90° ELBOWS

*NOL-TEC formed short radius elbows are available in carbon steel, stainless steel, or aluminum construction and are ideally suited for many dense phase pneumatic conveying applications.*



**OPTIONAL FEATURES:**

- Stainless steel or aluminum construction
- Flanged or grooved pipe connections
- Various pipe schedules and angles

SCHEDULE 10 CARBON STEEL ELBOW			
PIPE SIZE	A	B	C
2"	7.5"	2.38"	11.5"
3"	6"	3.5"	12"
4"	12"	4.5"	20"
5"	20"	5.56"	30"
6"	30"	6.63"	42"
8"	40"	8.63"	56"

SCHEDULE 40 CARBON STEEL ELBOW			
PIPE SIZE	A	B	C
2"	6"	2.38"	10"
3"	6"	3.5"	12"
4"	12"	4.5"	20"
5"	20"	5.56"	30"
6"	24"	6.63"	36"
8"	40"	8.63"	56"
10"	40"	10.75"	60"

*Dimensions may vary with material and pipe schedule. Specifications subject to change without notice.*

**Nol-Tec Systems, Inc.**

425 Apollo Drive  
Lino Lakes, MN 55014  
(651) 780-8600 • (651) 780-4400 fax  
sales@nol-tec.com • www.nol-tec.com